

MATERIALS & FEATURES

- ASTM A53 steel tubing
- U-lock compatible
- Slim and asthetic design

FINISH OPTIONS

- Black Duraplas (standard)

MOUNTING OPTIONS

- Surface mount - concrete (anchors sold separately)
- Rail Mount:
 - 4, 6, 8, 10, 12 bike rails
- Rail lengths:
 - 36", 66", 96", 126", 156"

SPACE USE

- Wall setbacks
 - Parallel to wall: minimum 24" to center of rack
 - Recommended 36" to center of rack
 - Perpenicular to wall: minimum 42" to center of rack

- Rack to rack
 - Minimum: 30" (standard for rail mount)
 - Recommended: 36"

- Street setbacks
 - Parallel to street: minimum 24" to center of rack*
 - Recommended 36" to center of rack*
 - Perpendicular to street: minimum 24" to edge of base flange*

*check local ordiances for minimum clearances

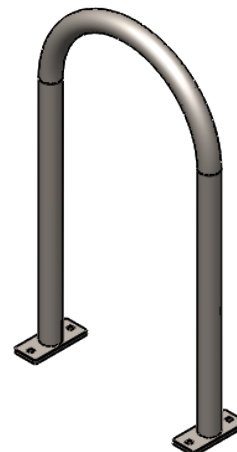

MULTI-CAPACITY RAIL SYSTEM

Radius 4, 6, 8, 10, and 12 bike rails

